



INDIAN SCHOOL NIZWA - WORKSHEET

ENVIRONMENTAL STUDIES

CH:5. CHHOTU'S HOUSE

Name: _____

Date: _____

Class III Sec: ____

I. Fill in the blanks:

We feel happy and safe at -----

Our ----- is our first school.

Each family has its own -----

II. Match the following

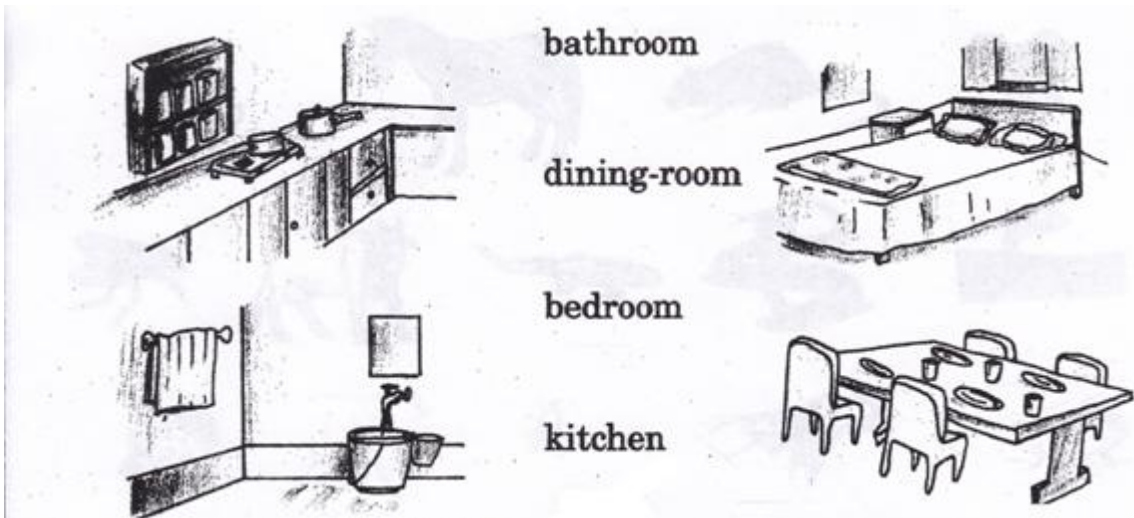

III. Tick the correct answers of following questions about Chhotu's House:

What did Chhotu think when he looked at the pipe?

1. (i) To make play area
- (ii) To make a place for stay

How did Chhotu use the pipe?

2. (i) As shelter
- (ii) As store room

Into which parts did Chhotu divide the pipe and its surrounding area?

3. (i) Sleeping area and cloth drying area
- (ii) Sleeping area and kitchen

In which part of his house will Chhotu like to spend most of his time?

4. (i) Inside the pipe
- (ii) Outside the pipe

IV Encircle the odd one:



INDIAN SCHOOL NIZWA - WORKSHEET

1. Bucket, Tub, Soap, Shampoo, Bed
2. Bed, Curtains, Bucket, Dressing table, Cupboard
3. Stove, Shower, Gas cylinder, Utensils, Coffee
4. Sofa, Television, Table, Sink, Chair

V Draw a picture of your house and colour it.

VI Chhotu divided the pipe into different parts. Write the names of the different parts of your house
Ans-----

V Draw pictures of any two animals that live in our house uninvited. Write their names below the pictures

VI Name any three things with which you decorate your house

Ans-----
